

## 3 LEDS METEORIT LIGHT HEAD

(Blue : 28136; White : 28137 ; Amber : 28138; Red : 28139)

Class 1 R65 approved High performance 3 leds light head

- Power voltage : 10-30V
- IP67 protection rating
- Plastic light body and black ABS housing
- Dimension (LxWxH): 90 x 34 x 22 (mm )
- 13 Flash patterns with R65 approved single Flash, double Flash and quad Flash patterns
- Synchronization possible up to 8 lights

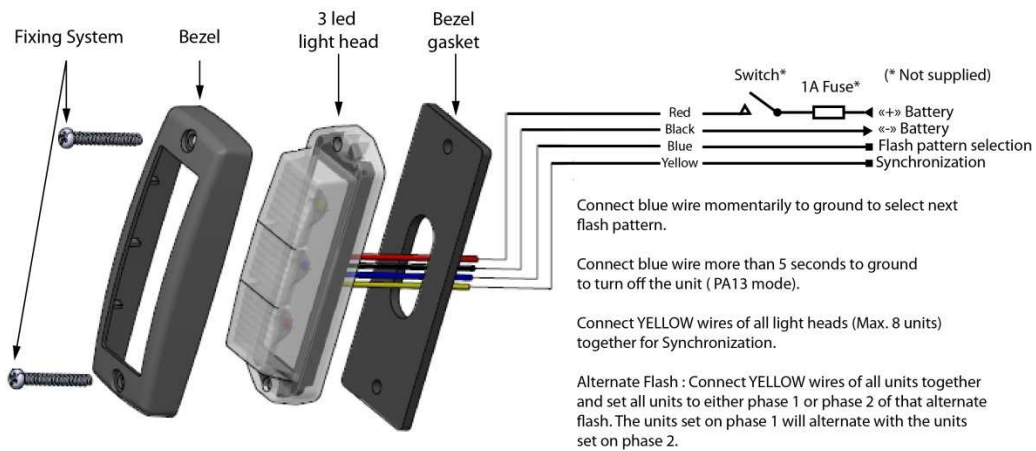

### FLASH PATTERNS

PA1	ECE R65 120FPM Single Flash phase 1 (Default)
PA2	ECE R65 120FPM Single Flash phase 2
PA3	ECE R65 120FPM Double Flash phase 1
PA4	ECE R65 120FPM Double Flash phase 2
PA5	ECE R65 120FPM Quad Flash phase 1
PA6	ECE R65 120FPM Quad Flash phase 2
PA7	Single Flash 75FPM phase 1
PA8	Single Flash 75FPM phase 2
PA9	Double Flash 75FPM phase 1
PA10	Double Flash 75FPM phase 2
PA11	Quad Flash 75FPM phase 1
PA12	Quad Flash 75FPM phase 2
PA13	Off

